

Manual Sliding Wall System



GEZE MSW



Römer Galerie, Leonberg



GEZE MSW

GEZE MSW is particularly suitable for innovative all glass solutions in pretentious building projects. A flexible building block principle and the integration of panels with different functions offers architects and planners a wide scope of design for the realization of individual sliding walls.

The sliding wall system MSW is conceived for hotels and congress halls, banks, shopping arcades, airports and much more. Very good running properties by using high-quality precision ball bearings for the carriage, silent operation, small energy expenditure when manual shifting the glass elements are pointed out.

- ▶ A maximum panel weight of 150 kg can be operated smoothly and with a minimum of noise due to the high quality precision ball bearings. The glass elements can be moved into the desired position with a minimum of effort.
- ▶ The panels are attached for the whole width of the element – at top and bottom – in carrier and clamping profiles. No drilling of the glass panels is required, eliminating the costs for drilling the glass and significantly reducing any associated causes for failure.
- ▶ GEZE MSW is an extremely installation-friendly system. The classic structural design, without the necessity for holes drilling into the glass, allows for a large range of tolerance. The carrier and clamping profiles can be pre-fitted in the works, allowing for a fast and error-free installation of the clamping profiles.
- ▶ Another advantage of the product is that the covers for carrier and clamping profiles can be clipped. The covers can be clipped on after installation has been completed. This gives added protection of the surfaces against damage and scratching during installation. If there is any damage at a later point, the profiles can be easily and swiftly replaced.
- ▶ The parking area for the divider elements can be arranged in parallel, 90° to the sliding axis or as a special parking recess.
- ▶ The selection of different surfaces and colours available provides architects and designers a good range of design options. The manual sliding wall system GEZE MSW fits well into the overall design of buildings of any style.





GEZE MSW

Sliding glass element as single- or double-action door (SBT)

Flexibility by functionality are the characteristics which make the GEZE MSW an outstanding system. Especially with SBT, sliding glass element as single- respectively double-action door.

The layout of sales areas and the presentation of goods are important factors for success of a shopping center. The wide glass elements of the GEZE MSW sliding wall system offer clear view and can also be used as single- or double-action doors with closing function.

If the MSW shop front is not to be opened, the sales areas can be entered by the single-action respectively double-action door. With only a few movements, an easy to handle mechanical locking device makes a fully functional swing door from a closed sliding element. By the use of two sliding glass elements as single-action or double-action door, wide openings can be realized.

The following variants of SBT, sliding glass elements as single- or double-action doors are available:

- ▶ sliding glass element as double-action door with floor spring GEZE TS 520
- ▶ sliding glass element as single-action door with overhead door closer GEZE TS 3000 V
- ▶ standard sliding glass element as single-action door





GEZE MSW

Technical details

Technical data of the manual sliding wall GEZE MSW:

- ▶ max. clear passage height 3500 mm
- ▶ max. panel width 1500 mm
- ▶ max. panel weight
 - up to 100 kg with single carriage
 - up to 150 kg with double carriage

The parking area for the divider elements can be arranged in parallel, at 90° to the sliding axis or as a special parking recess. All parking spaces can be designed with or without parking space screens, i.e. both double tracks as well as single tracks can be used.

The surfaces of the running track have a standard anodised aluminium finish in the colour EV1. When using a double running track it is also possible to use different types of anodised finish as well as powder coating in RAL colours. The geometry of the running tracks of the GEZE MSW manual sliding wall can be arranged straight, in a continuous curve or polygonally.

The glass panels of the GEZE MSW manual sliding wall system are held at the top and bottom over the whole width of the element by carrier and clamping profiles. Clip-on covers for the carrier and clamping profiles are available in two different versions (see page 7):

- ▶ following the contour of the carrier and clamping profile (standard)
- ▶ rectangular in shape

Horizontally the panel elements are sealed at the top and bottom through sealing brushes.

On request it is possible to supply a continuous floor track for the GEZE MSW manual sliding wall.

Bolting/locking

- ▶ floor bolting
- ▶ single lever safety lock (as floor lock) for profile cylinder with square lock nut





GEZE MSW

Technical details

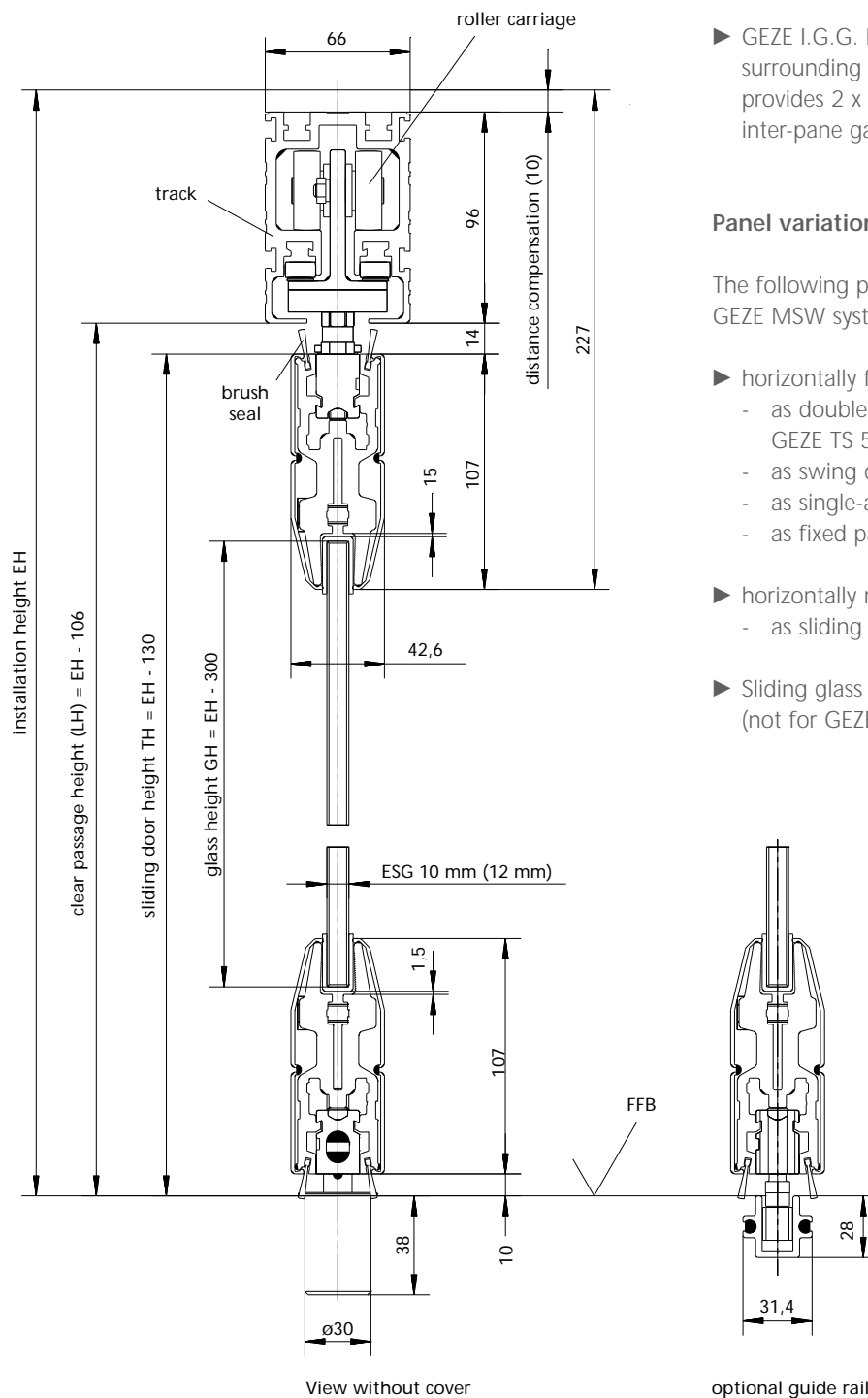

MSW - Monoglass

Glass panel versions

- ▶ All-glass panels with continuous carrier and clamping profilees at top and bottom, ESG, toughened glass 10 mm or 12 mm thick
- ▶ GEZE I.G.G. Integrated all-glass system with surrounding edge printing. Standard construction provides 2 x 6 ESG, toughened glass with an inter-pane gap (SZR) of 27 mm

Panel variations

The following panel options are available with the GEZE MSW system:

- ▶ horizontally fixed panels:
 - as double-action door with floor spring
GEZE TS 550
 - as swing door with floor bearing
 - as single-action door with external pivot bearing
 - as fixed panel
- ▶ horizontally moveable panels:
 - as sliding door
- ▶ Sliding glass element as double-action door (SBT) (not for GEZE I.G.G.)



GEZE MSW

Technical details

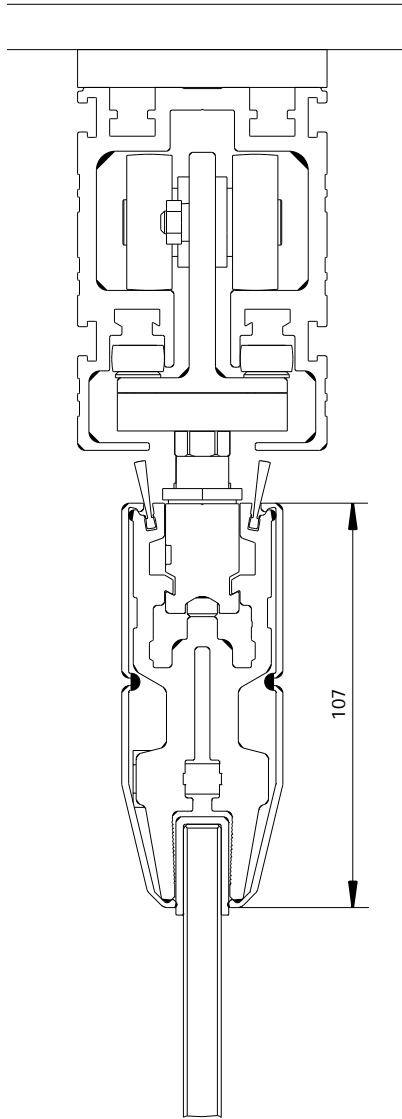

standard

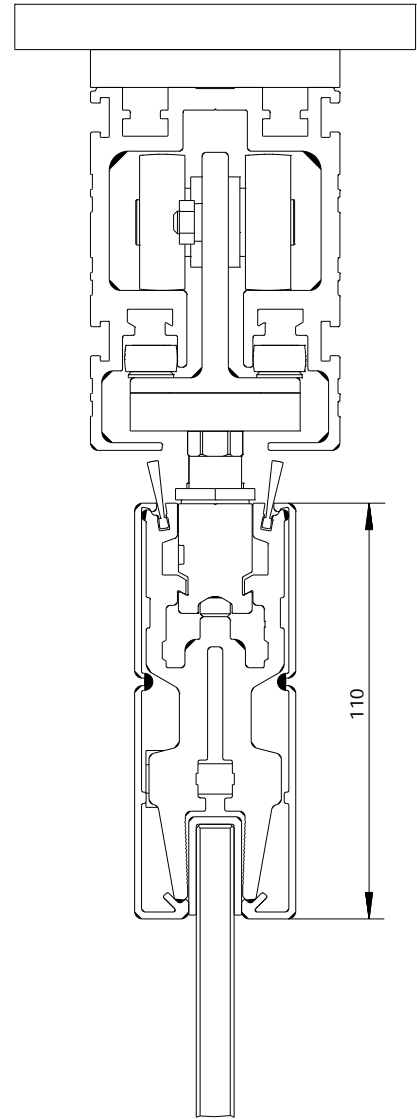

rectangular

Cover options for carrier and clamping profiles



GEZE MSW

Specification text

Manual sliding wall system **GEZE MSW**
fluently sliding manner by cornering technique,
fitting- and operating-parts integrated in profile,

max. door weight: 150 kg

Dimensions:

width: ca. mm (max. 1500 mm/door)

height: ca. mm (max. 3500 mm/door)

Running track:

- straight
- bent, radius mm (door straight, with that general view polygonal)
- changes of dimension, angle°

Version:

- without floor guide rail
- with floor guide rail

Division of leaves:

- ... pcs. double action door(s), fixed
with floor spring GEZE TS 550
- ... pcs. single-action door(s), fixed
without floor spring
- ... pcs. sliding door(s)
- ... pcs. fixed panels(s)
- sliding glass element as single-action or
double-action door

Technical features of the sliding glass element
as single-action or double-action door:

door height: max. 3000 mm

door width: max. 1100 mm

door weight: max. 90 kg

- ... pcs. sliding glass element as double-action door
with floor spring GEZE TS 520
- ... pcs. sliding glass element as swing door
with floor bearing
- ... pcs. sliding glass element as single-action door
with overhead door closer GEZE TS 3000 V

Cover:

- according to the shape of the fitting- and
clamping profiles, height 107 mm
- rectangular height H = 110 mm

- EV1 anodised (standard)
- powder coated RAL
- stainless steel design, anodised

Swing door locking:

floor lock for profile cylinder (lift 19 mm)

Parking space:

- with single running track (uncovered)
- with double running track (covered)

- single-sided
 - left (view from inside)
 - right (view from inside)
- double-sided

Parking space arrangement:

- 90° to the line of sliding wall
- parallel to the line of sliding wall
- special parking space according to drawing

Glass:

- ESG, toughened safety glass 10 mm (green glass)
- ESG, toughened safety glass 10 mm,
Diamant (white glass)
- ESG, toughened safety glass 12 mm (green glass)
- ESG, toughened safety glass 12 mm,
Diamant (white glass)
- I.G.G.
(ESG, toughened safety glass 6 mm
- SZR, gap between the panes 27 mm
- ESG, toughened safety glass 6 mm)
not for sliding glass element as double-action door
- imprint:
top and bottom, width 50 mm
left / right, width 45 mm
- special:
left / right: mm (min. 30 mm)
- colour imprint: according to RAL

Surface finishing of glass:

- silk-screen print,
specification:
- protection against the sun coating,
specification:
- special coating:

Seal:

- horizontal brush seal

GEZE GmbH

P.O. Box 1363
71226 Leonberg
Germany

GEZE GmbH

Reinhold-Vöster-Straße 21-29
71229 Leonberg
Germany
Telefon +49 (0) 7152-203-0
Telefax +49 (0) 7152-203-310

GEZE Online:

www.geze.com

GEZE branch offices**Germany****GEZE GmbH**

Niederlassung Nord/Ost
Bührlingstraße 8
13086 Berlin (Weissensee)
Tel. +49 (0) 30-47 89 90-0
Fax +49 (0) 30-47 89 90-17
E-mail: berlin.de@geze.com

GEZE GmbH

Niederlassung West
Nordsternstraße 65
45329 Essen
Tel. +49 (0) 201-83082-0
Fax +49 (0) 201-83082-20
E-mail: essen.de@geze.com

GEZE GmbH

Niederlassung Mitte
Adenauerallee 2
61440 Oberursel (b. Frankfurt)
Tel. +49 (0) 6171-63610-0
Fax +49 (0) 6171-63610-1
E-mail: frankfurt.de@geze.com

GEZE GmbH

Niederlassung Süd
Reinhold-Vöster-Straße 21-29
71229 Leonberg
Tel. +49 (0) 7152-203-594
Fax +49 (0) 7152-203-438
E-mail: leonberg.de@geze.com

GEZE subsidiaries**Germany****GEZE Sonderkonstruktionen GmbH**

Planken 1
97944 Boxberg-Schweigern
Tel. +49 (0) 7930-9294-0
Fax +49 (0) 7930-9294-10
E-mail: sk.de@geze.com

GEZE Service GmbH

Reinhold-Vöster-Straße 25
71229 Leonberg
Tel. +49 (0) 7152-9233-0
Fax +49 (0) 7152-9233-60
E-mail: info@geze-service.com

GEZE Service GmbH

Niederlassung Berlin
Bührlingstraße 8
13086 Berlin (Weissensee)
Tel. +49 (0) 30-470217-30
Fax +49 (0) 30-470217-33

Europe**Benelux****GEZE Benelux B.V.**

Leemkuil 1
Industrieterrein Kapelbeemd
5626 EA Eindhoven
Tel. +31 (0) 40-26290-80
Fax +31 (0) 40-26290-85
E-mail: benelux.nl@geze.com

France**GEZE France S.A.R.L.**

ZAC de l'Orme Rond
RN 19
77170 Servon
Tel. +33 (0) 1-60626070
Fax +33 (0) 1-60626071
E-mail: france.fr@geze.com

Great Britain**GEZE UK Ltd.**

Blenheim Way
Fradley Park
Lichfield
Staffordshire WS13 8SY
Tel. +44 (0) 1543-443000
Fax +44 (0) 1543-443001
E-mail: info@geze-uk.com

Italy**GEZE Italia Srl**

Via Giotto 4
20040 Cambiagio (MI)
Tel. +39 02 95 06 95-11
Fax +39 02 95 06 95-33
E-Mail italia.it@geze.it

GEZE Engineering Roma Srl

Via Lucrezia Romana 91
00178 Roma
Tel. +39 06-7265311
Fax +39 06-72653136
E-mail: gezeroma@libero.it

GEZE Engineering Bari Srl

Via Treviso 58
70022 Altamura (Bari)
Tel. +39 080-3115219
Fax +39 080-3164561
E-mail: gezebari@libero.it

Austria**GEZE Austria GmbH**

Mayrwiesstraße 12
5300 Hallwang b. Salzburg
Tel. +43 (0) 662-663142
Fax +43 (0) 662-663142-15
E-mail: austria.at@geze.com

Poland**GEZE Polska Sp. z o.o.**

ul. Annopol 3 (Zeran Park)
03-236 Warszawa
Tel. +48 (0) 22-8142211
Fax +48 (0) 22-6142540
E-mail: geze@geze.pl

Switzerland**GEZE Schweiz AG**

Bodenackerstrasse 79
4657 Dulliken
Tel. +41 (0) 62-285 54 00
Fax +41 (0) 62-285 54 01
E-mail: schweiz.ch@geze.com

Spain**GEZE Iberia S.R.L.**

Pol. Ind. El Pla
C/ Comerc, 2-22, Nave 12
08980 Sant Feliu de Llobregat (Barcelona)
Tel. +34-(0) 9-02 19 40 36
Fax +34-(0) 9-02 19 40 35
E-mail: iberia.es@geze.com

Scandinavia**Sweden****GEZE Scandinavia AB**

Mallslingan 10
Box 7060
18711 Täby
Tel. +46 (0) 8-7323-400
Fax +46 (0) 8-7323-499
E-mail: [sverige.se@geze.com](mailto: sverige.se@geze.com)

Norway**GEZE Scandinavia AB avd. Norge**

Postboks 63
2081 Eidsvoll
Tel. +47 (0) 639-57200
Fax +47 (0) 639-57173
E-mail: norge.se@geze.com

Finland**GEZE Finland**

Branch office of GEZE Scandinavia AB
Postbox 20
158 71 Hollola
Tel. +358 (0) 10-400 51 00
Fax +358 (0) 10-400 51 20
E-mail: finland.se@geze.com

Denmark**GEZE Denmark**

Branch office of GEZE Scandinavia AB
Møllehusene 3, 3. th.
4000 Roskilde
Tel. +45 (0) 46-323324
Fax +45 (0) 46-323326
E-mail: denmark.se@geze.com

Middle East**U.A.E.****GEZE Middle East**

P.O. Box 17903
Jebel Ali Free Zone
Dubai
Tel. +971 (0) 4-8833112
Fax +971 (0) 4-8833240
E-mail: geze@emirates.net.ae

Asia**GEZE Asia Pacific Ltd.**

Unit 630, Level 6, Tower 2
Grand Central Plaza
138 Shatin Rural Committee Road
Shatin, New Territories
Hong Kong
Tel. +852 (0) 237-57382
Fax +852 (0) 237-57936
E-mail: info@geze.com.hk

GEZE Industries (Tianjin) Co., Ltd.

Shuangchenzhong Road
Beichen Economic Development
Area (BEDA)
Tianjin 300400, P.R. China
Tel. +86 (0) 22-26973995-0
Fax +86 (0) 22-26972702
E-mail: geze@public1.tpt.tj.cn

GEZE Industries (Tianjin) Co., Ltd.

Branch Office Shanghai
Dynasty Business Center
Room 401-402
No. 457 WuRuMuQi North Road
200040 Shanghai, P.R. China
Tel. +86-(0)21-52 34 09-60/-61/-62
Fax +86-(0)21-52 34 09-63
E-mail: gezesh@geze.com.cn

GEZE Industries (Tianjin) Co., Ltd.

Branch Office Guangzhou
Room 1113, Jie Tai Plaza
218-222 Zhong Shan Liu Road
510180 Guangzhou
P.R. China
Tel. +86 (0) 20-813207-02
Fax +86 (0) 20-813207-05
E-mail: gezegz@public2.sta.net.cn

GEZE Industries (Tianjin) Co., Ltd.

Branch Office Beijing
The Grand Pacific Building
B Tower Room 201
8 A, Guanghua Road
Chaoyang District
100026 Beijing, P.R. China
Tel. +86-(0)10-65 81 57-32/-42/-43
Fax +86-(0)10-65 81 57 33
E-mail: gezebj@geze.com.cn

GEZE Asia Sales Ltd.

No. 88-1-408, East Road
Free Trade Zone of Tianjin Port
Tianjin, P.R. China
Tel. +86 (0)22-26 97 39 95-0
Fax +86 (0)22 26 97 27 02
E-mail: geze@public1.tpt.tj.cn

