

# MB10B

## FRAMELESS GLASS BATHROOM HARDWARE

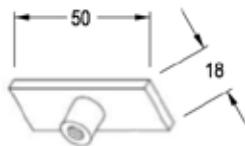

Product Image



Dimensions

### Ø10mm Dia Hole

(This allows a 1mm clearance to the edge of the backplate and bracket. A larger hole can be used but may be more noticeable)

Glass Preparation

### DETAILS

#### Glass Mounting Backplate for Shelf Brackets

- Suitable for 6mm, 8mm, 10mm & 12mm glass
- Glass hole diameter: 10mm (this allows a 1mm clearance. A larger hole can be used but may be more noticeable)

### FINISHES

- Polished & Brushed Satin Chrome
- Polished & Satin Gold
- Matt Black
- Brushed Nickel
- Other finishes available by request

Base Material: Brass