



TM

© Copyright

P 02 9522 3983

E customer.service@mfgs.com.au

www.mfgs.com.au

MFGS

MODERN FRAMELESS  
GLASS SYSTEMS

## ONYX™ SQUARE CUT 5081

PERIMETER FRAMED SHOWER SCREEN SYSTEM WITH FRAMELESS HINGED DOOR

## CUTTING SHEET

DESIGN CODE: 5081SC PF1FP45R

JOB NO. \_\_\_\_\_ DATE \_\_\_\_ / \_\_\_\_ / \_\_\_\_

## CLIENT DETAILS

NAME: \_\_\_\_\_

ADDRESS: \_\_\_\_\_

PHONE NO: \_\_\_\_\_

EMAIL: \_\_\_\_\_

## PRODUCT DETAILS

APPLICATION: **FRONT WITH 1 FIXED PANEL & 45° RETURN**

PANEL TYPE: \_\_\_\_\_

COLOUR: \_\_\_\_\_

OTHER: \_\_\_\_\_

## SCHEMATIC

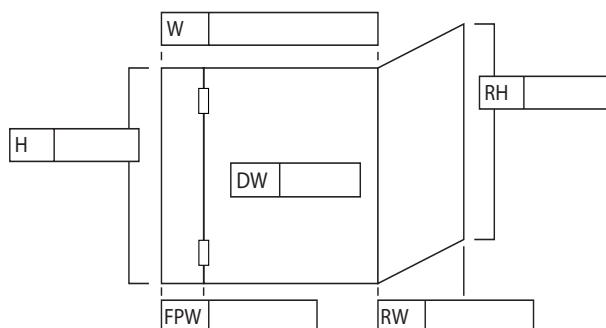

PLEASE INDICATE SHOWER ENCLOSURE HAND

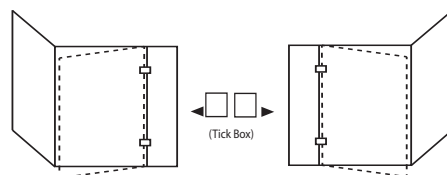

## CUTTING FORMULA HEIGHT GUIDE

	PRODUCT CODE	DESCRIPTION	QTY	CUTTING FORMULA	EXTRUSION LENGTH
FRONT	SE131	Head/Sill	1	H - 72	
	SE58	Wall Channel	1	H	
	<b>Note:</b> Square cut ends.				
RETURN PANEL	SE131	Head/Sill	1	RH - 72	
	SE58	Wall Channel	1	RH	
	<b>Note:</b> Square cut ends.				

## GLASS SPECIFICATION GUIDE

	DIMENSIONS	QTY	FORMULA	SPEC
DOOR	Height	1	H - 75	
	Width	1	DW	
	<b>Note:</b> Door width as required. All edges to be flat polished.			
FIXED PANEL	Height	1	H - 38	
	Width	1	FPW - 43	
	<b>Note:</b> Cut out edge to be flat polished.			
RETURN PANEL	Height	1	H - 38	
	Width	1	RW - 32	
	<b>Note:</b> Back mitre one vertical edge at 45° and flat polished.			

## CUTTING FORMULA WIDTH GUIDE

	PRODUCT CODE	DESCRIPTION	QTY	CUTTING FORMULA	EXTRUSION LENGTH
FRONT	SE131	Head/Sill	2	W - 63	
	<b>Note:</b> Square cut ends. Use smallest width dimensions.				
RETURN PANEL	SE131	Head/Sill	2	RW - 63	
	<b>Note:</b> Square cut ends. Use smallest width dimensions.				

## SPECIAL NOTES

- Refer to glass preparation and dimension guide.
  - All deductions from mid-point adjustment range on wall channels.
  - Assumes use of 6mm toughened glass.
  - Include 8mm hole on door glass for handle.
- Note:** If SEBWS: Bulb Water Seal required amend fixed panel width deduction from - 43 to - 47.