



© Copyright

P 02 9522 3983

E customer.service@mfgs.com.au

www.mfgs.com.au



MODERN FRAMELESS  
GLASS SYSTEMS

# ONYX™ SQUARE CUT 5081

PERIMETER FRAMED SHOWER SCREEN SYSTEM WITH FRAMELESS HINGED DOOR

## CUTTING SHEET

**DESIGN CODE: 5081SC PF1FP90R**

JOB NO. \_\_\_\_\_ DATE \_\_\_\_/\_\_\_\_/\_\_\_\_

### CLIENT DETAILS

NAME: \_\_\_\_\_  
 ADDRESS: \_\_\_\_\_  
 PHONE NO: \_\_\_\_\_  
 EMAIL: \_\_\_\_\_

### PRODUCT DETAILS

APPLICATION: **FRONT WITH 1 FIXED PANEL & 90° RETURN**  
 PANEL TYPE: \_\_\_\_\_  
 COLOUR: \_\_\_\_\_  
 OTHER: \_\_\_\_\_

### SCHEMATIC

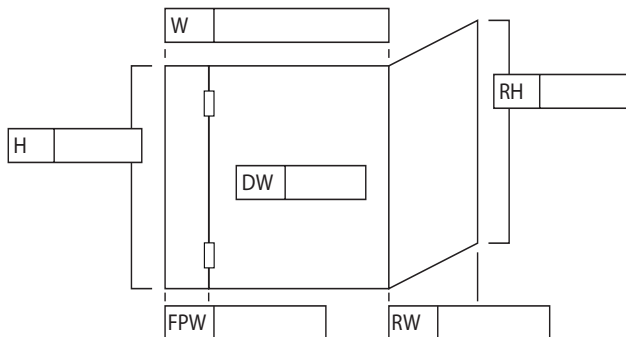

PLEASE INDICATE SHOWER ENCLOSURE HAND

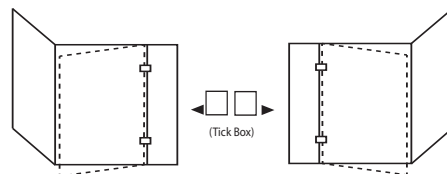

### CUTTING FORMULA HEIGHT GUIDE

	PRODUCT CODE	DESCRIPTION	QTY	CUTTING FORMULA	EXTRUSION LENGTH
FRONT	SE131	Head/Sill	1	H - 72	
	SE58	Wall Channel	1	H	
	<b>Note:</b> Square cut ends.				
RETURN PANEL	SE131	Head/Sill	1	RH - 72	
	SE58	Wall Channel	1	RH	
	<b>Note:</b> Square cut ends.				

### GLASS SPECIFICATION GUIDE

	DIMENSIONS	QTY	FORMULA	SPEC
DOOR	Height	1	H - 75	
	Width	1	DW	
	<b>Note:</b> Door width as required. All edges to be flat polished.			
FIXED PANEL	Height	1	H - 38	
	Width	1	FPW - 49	
	<b>Note:</b> Cut out edge to be flat polished.			
RETURN PANEL	Height	1	RH - 38	
	Width	1	RW - 37	
	<b>Note:</b> Two vertical edges to be flat polished.			

### CUTTING FORMULA WIDTH GUIDE

	PRODUCT CODE	DESCRIPTION	QTY	CUTTING FORMULA	EXTRUSION LENGTH
FRONT	SE131	Head/Sill	2	W - 78	
	<b>Note:</b> Square cut ends. Use smallest width dimensions.				
RETURN PANEL	SE131	Head/Sill	2	RW - 78	
	<b>Note:</b> Square cut ends. Use smallest width dimensions.				

### SPECIAL NOTES

- Refer to glass preparation and dimension guide.
  - All deductions from mid-point adjustment range on wall channels.
  - Assumes use of 6mm toughened glass.
  - Include 8mm hole on door glass for handle.
- Note:** If **SEBWS: Bulb Water Seal** required amend fixed panel width deduction from FPW - 49 to FPW - 53.